

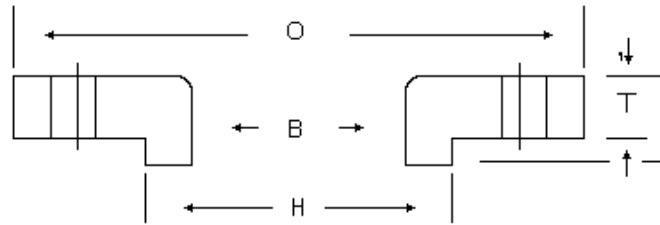

ASTM A-105 Forged Steel 150# Lap-Joint S/O Flanges

ANSI 150# S/O Pattern*
 W/Lap-Joint Radius
 Primer-Painted and Hot-Dip Galvanized
 Dimensions in Inches



Nominal Size	Outside Diameter (OD)	Bore Diameter (B)	No. of Bolt Holes	Bolt Hole Diam.	Bolt Circle (BC)	Thickness (T)	Hub Length (L)	Hub Diam. (H)	Lap Radius (R)	Approx. Weight (lbs)
1	4.25	1.38	4	0.625	3.13	0.563	0.688	1.938	0.13	2
1 1/4	4.68	1.72	4	0.625	3.50	0.625	0.813	2.312	0.19	3
1 1/2	5.00	1.97	4	0.625	3.88	0.688	0.875	2.563	0.25	3
2	6.00	2.46	4	0.750	4.75	0.750	1.000	3.063	0.31	5
2 1/2	7.00	2.97	4	0.750	5.50	0.875	1.125	3.563	0.31	7
3	7.50	3.60	4	0.750	6.00	0.938	1.188	4.250	0.38	8
3 1/2	8.50	4.10	8	0.750	7.00	0.938	1.250	4.812	0.38	11
4	9.00	4.60	8	0.750	7.50	0.938	1.312	5.312	0.44	13
5	10.00	5.69	8	0.875	8.50	0.938	1.438	6.438	0.44	15
6	11.00	6.75	8	0.875	9.50	1.000	1.562	7.562	0.50	18
8	13.50	8.75	8	0.875	11.75	1.125	1.750	9.688	0.50	30
10	16.00	10.92	12	1.000	14.25	1.188	1.938	12.000	0.50	42
12	19.00	12.92	12	1.000	17.00	1.250	2.188	14.375	0.50	64
14	21.00	14.19	12	1.125	18.75	1.375	2.250	15.750	0.50	90
16	23.50	16.19	16	1.125	21.25	1.438	2.500	18.000	0.50	98
18	25.00	18.20	16	1.250	22.75	1.562	2.688	19.875	0.50	125
20	27.50	20.25	20	1.250	25.00	1.688	2.875	22.000	0.50	160
24	32.00	24.25	20	1.375	29.50	1.875	3.250	26.125	0.50	212
30**	38.75	30.25	28	1.375	36.00	2.125	3.500	32.750	0.50	305
36**	46.00	36.25	32	1.625	42.75	2.375	3.750	39.250	0.50	440

Bore Diameters listed above are stocked by CAB as standard. Larger or special bores are available on application.

* Hub lengths shown for 14" - 24" sizes are standard 150# S/O dimension. They do not conform to full ANSI B16.5 Hub Length dimensions which are available on application.

** 30/36" sizes listed are Class 125 (Full Weight) S/O pattern with Lap-Joint ID. Sizes larger than 24" are not covered by ANSI B16.5.

Corporate Headquarters

CAB Incorporated
 4161 Chamblee Road, Oakwood, GA USA 30566
 800/241-7311 770/965-8180 Fax 770/965-8175
 www.cabinc.com email: sales@cabinc.com

Texas Manufacturing Facility

CAB Incorporated
 2306 Rayburn Drive, Nacogdoches, TX USA 75961
 800/435-2643 936/569-9430 Fax 936/569-0795