

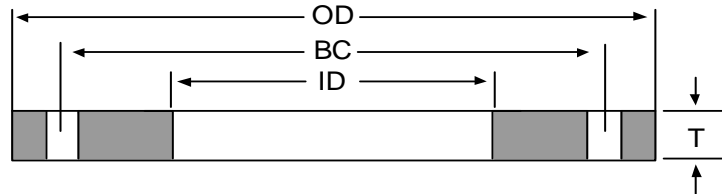

ASTM A-36 Ring Flanges, Metal Hose Thickness

150# Drilling
Dimensions in Inches



| Nominal Pipe Size | Outside Diameter (OD) | Inside Diameter (ID) | Thickness (T) | Bolt Circle (BC) | Hole Diameter (BC) | No. of Bolt Holes | Approx. Weight (lbs) |
|-------------------|-----------------------|----------------------|---------------|------------------|--------------------|-------------------|----------------------|
| 2 | 6.00 | 2.44 | 0.625 | 4.75 | 0.750 | 4 | 4.0 |
| 2.5 | 7.00 | 2.94 | 0.625 | 5.50 | 0.750 | 4 | 5.4 |
| 3 | 7.50 | 3.57 | 0.625 | 6.00 | 0.750 | 4 | 5.8 |
| 4 | 9.00 | 4.57 | 0.625 | 7.50 | 0.750 | 8 | 7.9 |
| 5 | 10.00 | 5.66 | 0.750 | 8.50 | 0.875 | 8 | 10.6 |
| 6 | 11.00 | 6.72 | 0.750 | 9.50 | 0.875 | 8 | 11.9 |
| 8 | 13.50 | 8.72 | 1.000 | 11.75 | 0.875 | 8 | 22.8 |
| 10 | 16.00 | 10.88 | 1.000 | 14.25 | 1.000 | 12 | 27.8 |
| 12 | 19.00 | 12.88 | 1.000 | 17.00 | 1.000 | 12 | 41.8 |
| 14 | 21.00 | 14.19 | 1.000 | 18.75 | 1.125 | 12 | 51.2 |
| 16 | 23.50 | 16.19 | 1.250 | 21.25 | 1.125 | 16 | 77.0 |
| 18 | 25.00 | 18.19 | 1.250 | 22.75 | 1.250 | 16 | 77.8 |
| 20 | 27.50 | 20.19 | 1.125 | 25.00 | 1.250 | 20 | 81.4 |
| 22 | 29.50 | 22.19 | 1.250 | 27.25 | 1.375 | 20 | 94.6 |
| 24 | 32.00 | 24.19 | 1.250 | 29.50 | 1.375 | 20 | 116.3 |
| 26 | 34.25 | 26.19 | 1.375 | 31.75 | 1.375 | 24 | 135.2 |
| 28 | 36.50 | 28.19 | 1.375 | 34.00 | 1.375 | 28 | 148.3 |
| 30 | 38.75 | 30.19 | 1.375 | 36.00 | 1.375 | 28 | 168.6 |
| 32 | 41.75 | 32.19 | 1.625 | 38.50 | 1.625 | 28 | 228.9 |
| 36 | 46.00 | 36.19 | 1.625 | 42.75 | 1.625 | 32 | 267.7 |

Corporate Headquarters

CAB Incorporated
4161 Chamblee Road, Oakwood, GA USA 30566
800/241-7311 770/965-8180 Fax 770/965-8175
www.cabinc.com email: sales@cabinc.com

Texas Manufacturing Facility

CAB Incorporated
2306 Rayburn Drive, Nacogdoches, TX USA 75961
800/435-2643 936/569-9430 Fax 936/569-0795