

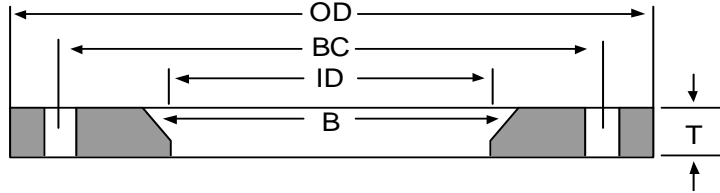

ASTM A-36 Carbon Steel Back-up Flanges

Style "LN" - Beveled ID
 150# Drilling
 Stub-End Applications
 Dimensions in Inches



Nominal Pipe Size	Outside Diameter (OD)	Inside Diameter (ID)	Thickness (T)	Bolt Circle (BC)	Hole Diameter	No. of Bolt Holes	45 Degree Bevel (B)	Approx. Weight (lbs)
Drilling Pattern - 150#								
2	6.00	2.46	0.500	4.75	0.750	4	0.250	2.9
2 1/2	7.00	3.00	0.500	5.50	0.750	4	0.250	4.2
3	7.50	3.60	0.500	6.00	0.750	4	0.250	4.4
4	9.00	4.60	0.500	7.50	0.750	8	0.250	5.6
5	10.00	5.69	0.500	8.50	0.875	8	0.250	6.9
6	11.00	6.75	0.625	9.50	0.875	8	0.250	9.1
8	13.50	8.75	0.625	11.75	0.875	8	0.312	12.9
10	16.00	10.95	0.625	14.25	1.000	12	0.312	16.2
12	19.00	12.95	0.750	17.00	1.000	12	0.312	29.3
14	21.00	14.20	0.750	18.75	1.125	12	0.312	36.2
16	23.50	16.20	0.750	21.25	1.125	16	0.375	42.0
18	25.00	18.20	0.750	22.75	1.250	16	0.375	42.3
20	27.50	20.25	0.750	25.00	1.250	20	0.375	49.7
22	29.50	22.25	1.000	27.25	1.375	20	0.375	73.7
24	32.00	24.25	1.000	29.50	1.375	20	0.375	86.4
26	34.25	26.25	1.000	31.75	1.375	24	0.375	97.5
30	38.75	30.38	1.000	36.00	1.375	28	0.375	113.1
32	41.75	32.38	1.125	38.50	1.625	28	0.375	153.4
36	46.00	36.38	1.125	42.75	1.625	32	0.375	175.5

Larger sizes thru 144" pipe diameter available on request.

Corporate Headquarters

CAB Incorporated
 4161 Chamblee Road, Oakwood, GA USA 30566
 800/241-7311 770/965-8180 Fax 770/965-8175
www.cabinc.com email: sales@cabinc.com

Texas Manufacturing Facility

CAB Incorporated
 2306 Rayburn Drive, Nacogdoches, TX USA 75961
 800/435-2643 936/569-9430 Fax 936/569-0795